

Commercial areas, open space areas or building sites

Location Brake – B03

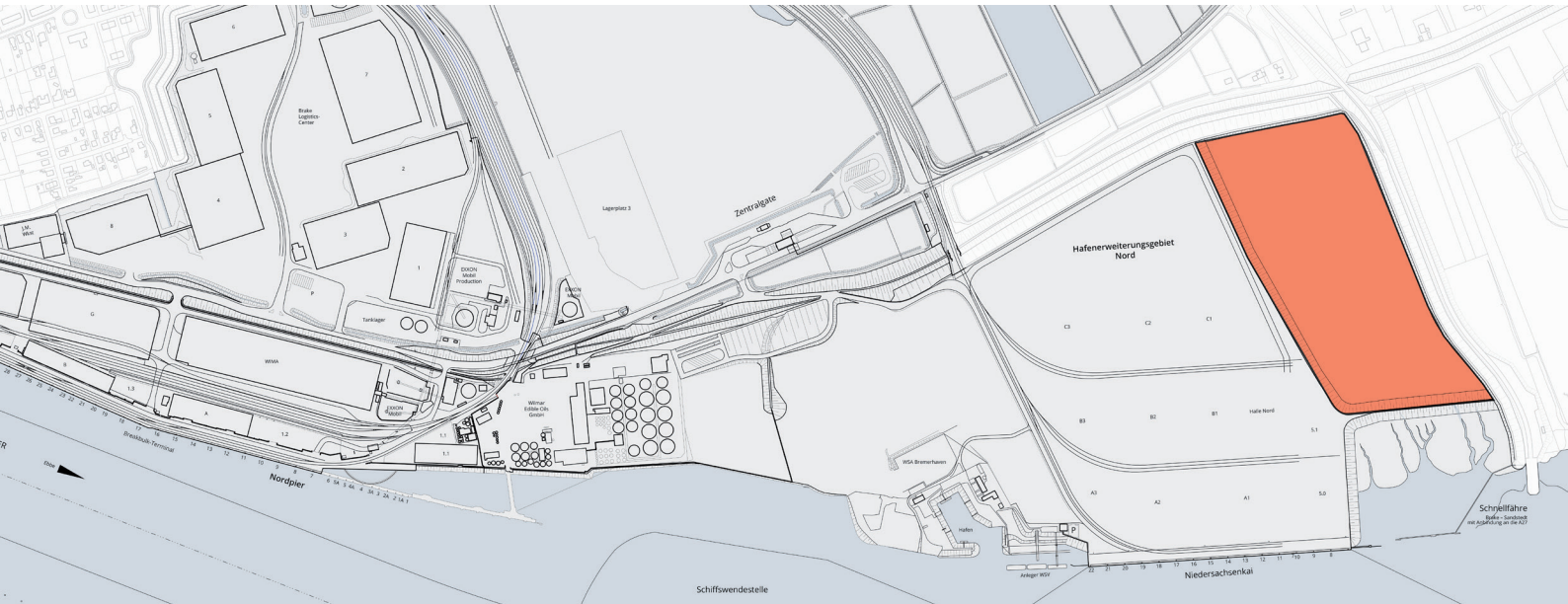

Golzwarden – northern part

Address	Port area of Brake Nordstraße 26919 Brake
Details about the object / Object description	
Object	<ul style="list-style-type: none"> › abt. 13 ha undeveloped surface area › the terrain is safe from high water flooding › heavy cargo transshipment up to 1,000 metric tons possible
Availability / Type of contract	<ul style="list-style-type: none"> › entire area available immediately › area can be made available as total area or in parcels › building lease contract, optional lease contract
Commercial utilization / Zoning plan	SO-Port as per zoning plan B69
Land use and zoning plan / Construction	cubic index 8.0-10.0 / site coverage 0.8
Restrictions / Official requirements	the height of building facilities is restricted to an overall height of 60 m
Target businesses	cargo handling related usage, port services

Golzwarden – northern part

Infrastructure / Connection to traffic routes – by land –

Road connection	<ul style="list-style-type: none"> › Nordstraße › federal highway B 212 / B 211 › connection to Autobahn via Wesertunnel A27 abt. 15 km
Rail connection	<ul style="list-style-type: none"> › direct access to the port railway, extendable › from there, access to the DB (fed. German rail network)

Infrastructure / Connection to traffic routes – on the water –

Quay facility	<ul style="list-style-type: none"> › Niedersachsenkai › quay length 450 m › permissible draft 11.90m › superstructure: 2 mobile cranes, hoisting capacity 140 metric tons › 3rd berth is in development at present
---------------	---

Distances

Airport	Bremen abt. 60 km
Inner city of Brake	abt. 2,5 km
Bremen	abt. 60 km
Bremerhaven	abt. 40 km
Hamburg	abt. 185 km
Hannover	abt. 190 km
Duisburg	abt. 280 km

Your Contact:

Niedersachsen Ports GmbH & Co. KG

Branch Brake
Brommystraße 2
26919 Brake

Cornelia Stahnke
Head of Real Estate Brake
T.: +49 (0) 4401 925-150
cstahnke@nports.de

Niedersachsen Ports GmbH & Co. KG

Branch Cuxhaven
Am Schleusenpriel 2
27472 Cuxhaven

Dirk Leibfried
Head of Marketing & Sales
T: +49 (4721) 500-173
dleibfried@nports.de